

Ground Floor (235.10 sqm - gross internal)

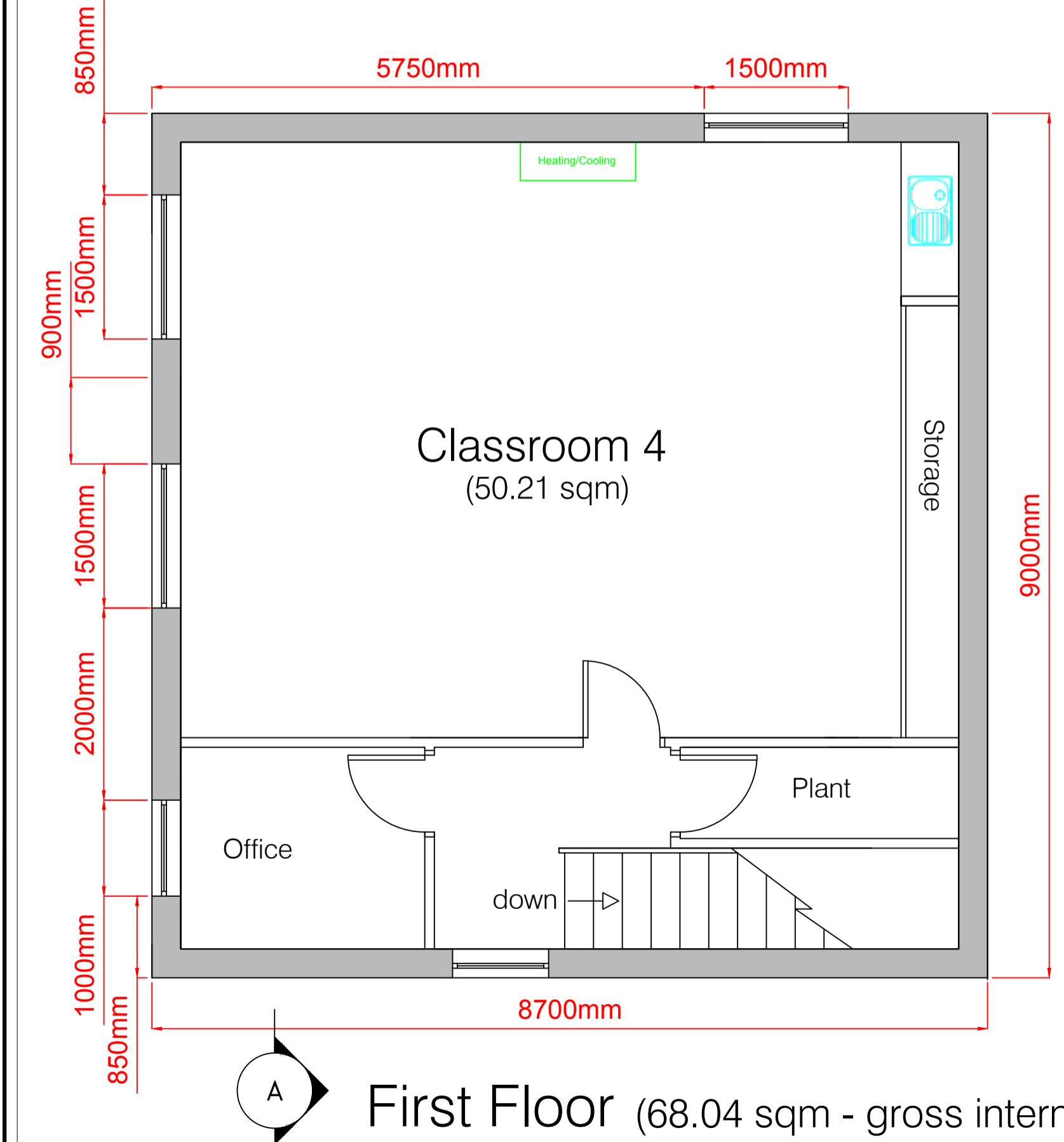

First Floor (68.04 sqm - gross internal)

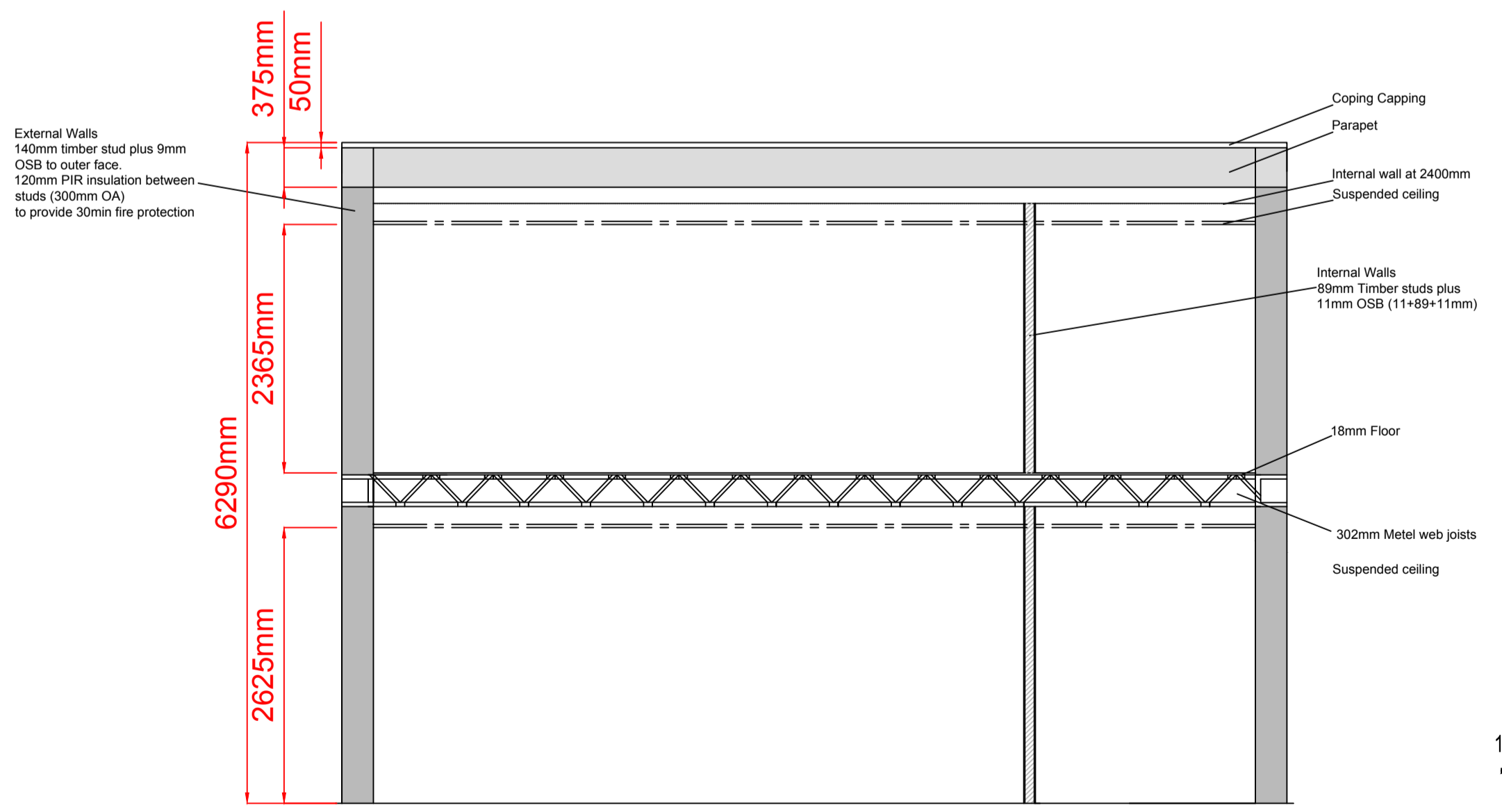

For Footing information see ChalkwellPlan4 Footings Detail

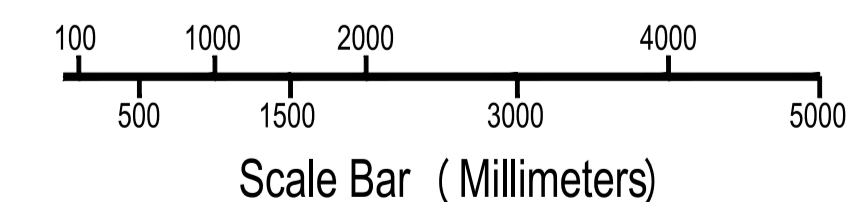

KEY

ALL DIMENSIONS IN MM  
 THE COPYRIGHT OF THIS DRAWING IS THE PROPERTY OF BROADWATER GROUP LTD WITHOUT WHOSE EXPRESSED WRITTEN CONSENT IT MAY NOT BE USED, PUBLISHED OR REPRODUCED IN ANY FORM.  
 ALL DIMENSIONS TO BE CHECKED ON SITE.

DATE	REVISIONS	REV
21/03/19	Gross Internal Area Figures Included	A
28/04/19	Layout Change + Reduction to 1st Floor	B
29/04/19	Layout Change to Ground Floor	C
30/04/19	Layout Change to Breakout and storage	D
02/05/19	Change after Council Comments	E

**- Broadwater Management -**  
 Project Management and Consultancy  
 18 Broadwater Lane, Towcester, Northants NN12 6YF  
 Tele: 01327 359134 Fax: 01327 359543  
 Mob: 07765 791425 Car: 07707 262039  
 Email: b-owen@btconnect.com

CLIENT:  
 Chalkwell Hall Infant School  
 Leigh-on-Sea  
 Essex  
 SS9 3NL

DRAWING TITLE:  
 Proposed Replacement Building  
 Layout Plan and Section

SCALE :	DATE :	DRAWN BY :
1:50 @ A1	21/03/19	B.Walker
		CHECKED BY :
		B.Owen

DRAWING NO:  
 ChalkwellPlan1 Rev E